

CITY OF CAPE TOWN (KHAYELITSHA-/ MITCHELLS PLAIN)

AMENDED DECLARATION OF PLACES WHERE THE CARRYING ON OF THE BUSINESS OF STREET VENDOR, PEDLAR OR HAWKER IS PROHIBITED/RESTRICTED: MITCHELL'S PLAIN TOWN CENTRE CAPE TOWN MUNICIPAL AREA

Notice is hereby given in terms of Section 6A(2)(h) of the Businesses Act 71 of 1991 that the notice published in the Provincial Government Gazette No 5408 dated 24 December 1999 is hereby replaced by the following notice: that the area shown by the figure A, B, C and D within Spine Road, Merrydale Road, A Z Berman and Wespoort Roads within the Mitchell's Plain Town Centre, Cape Town Municipal area, as shown on Map A accompanying this notice, is an area in which the carrying on of the business of street vendor, pedlar or hawker is prohibited, with the exception of the indicated informal trading sites numbered 1 to 1107 on the Maps marked 1 to 13 on the plans accompanying this notice.

The area constituted by the trading sites reflected on the plans is hereby declared an area in which the carrying on of the business of street vendor, pedlar or hawker is restricted to persons in possession of a valid permit or lease, and that the trading sites mentioned above be let out by means of a permit/lease, and that no street vending, peddling or hawking be permitted in the informal trading sites if a person is not in possession of a valid permit/lease for that particular trading site.

This notice shall take effect on the date of publication in the Official Gazette.

ACHMAT EBRAHIM, CITY MANAGER

16 October 2009

19022

STAD KAAPSTAD (KHAYELITSHA-/ MITCHELLS PLAIN-DISTRIK)

GEWYSIGDE VERKLARING VAN PLEKKE WAAR HANDEL DRYF AS STRAATVERKOPER, VENTER OF SMOUS VERBODE/BEPERK IS: MITCHELLS PLAIN-DORPSENTRUM, KAAPSTADSE MUNISIPALE GEBIED

Kennis geskied hiermee ingevolge artikel 6A(2)(h) van die Wet op Besighede, Wet 71 van 1991, dat die kennisgewing gepubliseer in Provinsiale Staatskoerant nr 5408 van 24 Desember 1999 hiermee met die volgende kennisgewing vervang word: dat die gebied aangetoon deur die figuur A, B, C en D binne Spineweg, Merrydaleweg, A Z Bermanrylaan en Wespoortweg in die Mitchells Plain-dorpsentrum, Kaapstadse munisipale gebied, soos aangetoon op kaart A wat by hierdie kennisgewing aangeheg is, 'n gebied is waar handel dryf as straatverkoper, venter of smous verbode is, met die uitsondering van die aangeduide informelehandelspersele genommer 1 tot 1107 op die kaarte gemerk 1 tot 13 wat by hierdie kennisgewing aangeheg is.

Die gebied van die handelspersele op die planne weergegee, word hiermee verklaar as 'n gebied waar handel dryf as straatverkoper, venter of smous beperk word tot diegene wat oor 'n geldige permit of huurkontrak beskik, en dat geen straatverkopery, ventery of smousery op die informelehandelspersele toegelaat word indien die persoon nie oor 'n geldige permit of huurkontrak vir daardie besondere handelsperseel beskik nie.

Hierdie kennisgewing tree op die datum van publikasie in die amptelike Staatskoerant in werking.

ACHMAT EBRAHIM, STADSBESTUURDER

16 Oktober 2009

19022

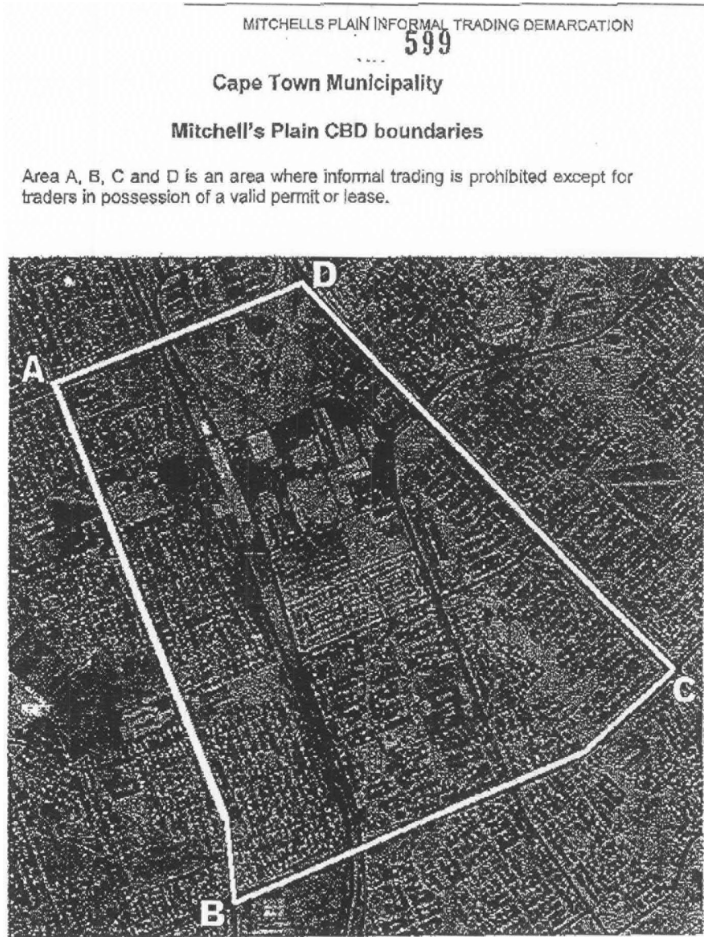

Map A

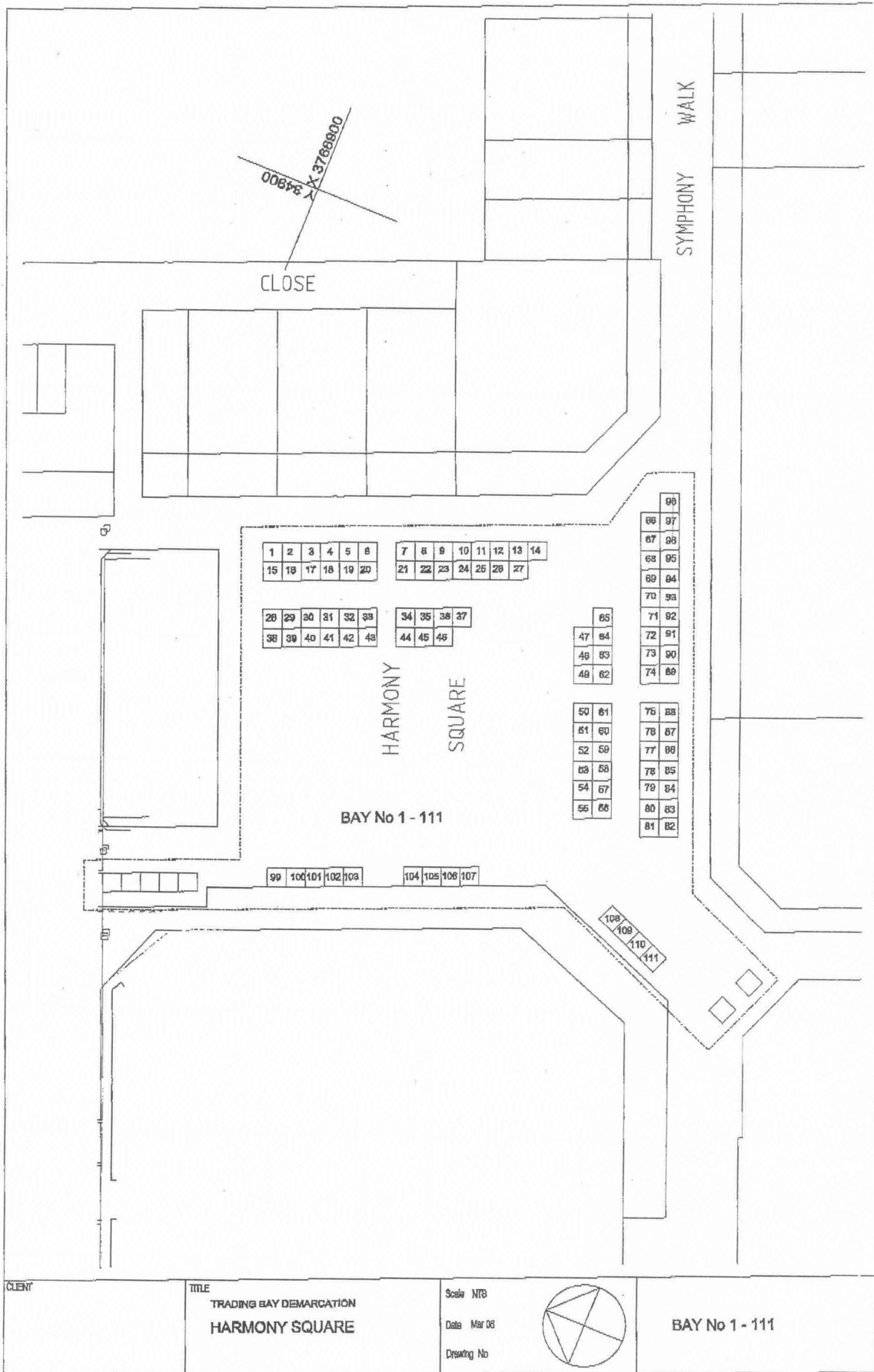

CLIENT

TITLE  
 TRADING BAY DEMARCATION  
 HARMONY SQUARE

Scale NTS  
 Date Mar 08  
 Drawing No

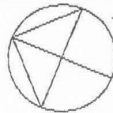

BAY No 1 - 111



